

RPX[®] SOLUTIONS

RPX[®] SUSPENSION CLAMP

FEATURES

- Ease of installation allows for faster overall network construction
- Has a wide range of angular usage, reducing the occurrences of Double Dead-End applications
- Designed for fast installation without the use of a rubber insert
- Protects the cable from attenuation by not allowing the cable to bend more than 40 degrees from center of clamp

INSTALLATION OPTIONS

- Option 1: PSC2080237 J-Hook (shown on right)
- Option 2: Eye nut & shackle

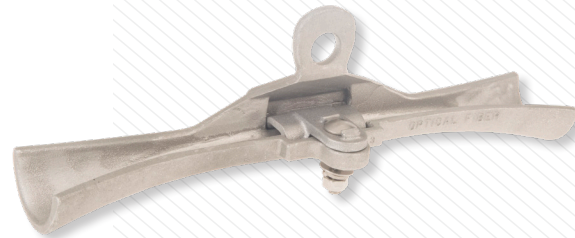

Catalog Number	Size Range	Deviation Angle	Maximum Span		Span Differential		Tension Differential		Initial	Quantity
			FT	M	FT	M	LBF	N	%	#
HUBRPXSUS	48f - 144f	up to 20°	262	80	98	30	150	667	1-3	10

Notes: For Cable installation instructions, contact Corning Cable Systems. Span differential is the difference in span length on each side of the clamp. Tension differential is also known as unbalanced load. Reference suspension clamp installation instructions for additional detail on installation options.

RPX[®] WEDGE DEADEND

FEATURES

- Easy, quick, and safe deadending of RPX[®] cable
- Installation take seconds with no special tools

Catalog Number	Clamo Body			Bail Length (in)	Standard Pack
	Length (in)	Width (in)	Height (in)		
WEGRPX	7.9	3.3	1.7	21.3	30



STORAGE LOOP

Opti-Loop's fiber cable bend radius management system optimizes the preferential bend of the RPX[®] Ribbon Cable while ensuring a stress free environment for the optical fibers.

Catalog Number	Size (in)	Length (in)	Outer Diameter (in)
FOSDA-17-ADSS	17	26	17.5
FOSDA-12-ADSS	12	18	13.1

